

EV100-12

Awaiting Image

Physical Specification

Part Number	EV100-12
Length	329 ± 2 mm
Width	173 ± 2 mm
Container Height	235 ± 2 mm
Total Height (with terminal)	235 ± 2 mm
Approx Weight	30.5 kg

Specifications

	Nominal Voltage	12V
	Nominal Capacity	100AH
Terminal Type	Standard Terminal	F11
Container Material	Standard Option	ABS
Rated Capacity	10hr, 1.80V/cell, 25°C	100AH
	2hr, 1.75V/cell, 25°C	77.7AH
Max Discharge Current	1000A (5s)	
Internal Resistance	Approx 4m Ω	
Charging Characteristics	Recommended Maximum Charging Current	27.5A
	Nominal Operating Temp. Range	25±3°C
	Cycle Use	14.60 ~ 14.80 at 25°C Temp.
	Standby Use	No limit on Initial Charging Current Voltage 13.60V ~ 13.80V at 25°C Temp.
	Capacity affect by Temperature	40°C 102%
		25°C 100%
		0°C 85%
Design Floating Life at 20°C	12+ Years	
Self Discharge	Ultracell batteries may be stored for up to 6 months at 25°C(77°F) and then a refresh charge is required. For higher temperatures the time interval will be shorter.	

Dimensions

F11 Terminal

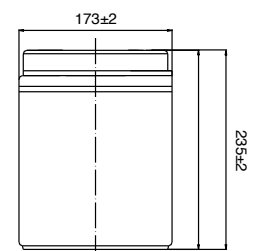
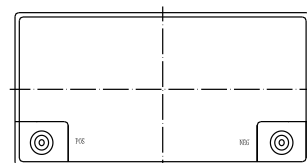
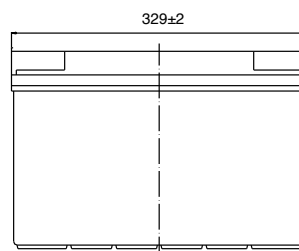
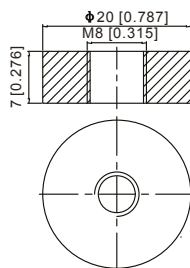

The Relationship for Open Circuit Voltage and Residual Capacity (25C)

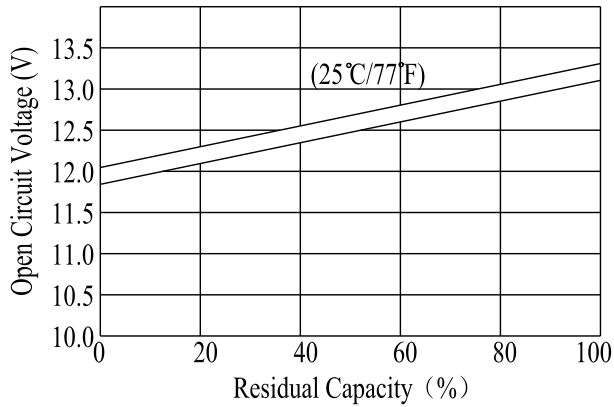

The Relationship for Charging Voltage and Ambient Temperature

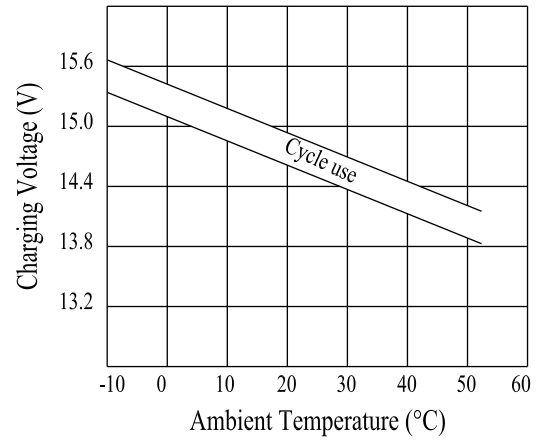

Cycle Life @ 5A Discharge(25C)

